

# PRO X SUPERLIGHT 2c

SETUP GUIDE | GUIDE D'INSTALLATION

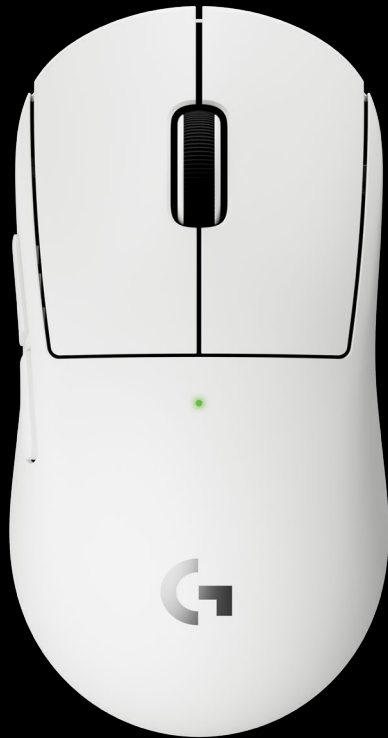

logitech

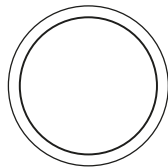
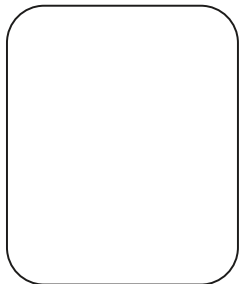
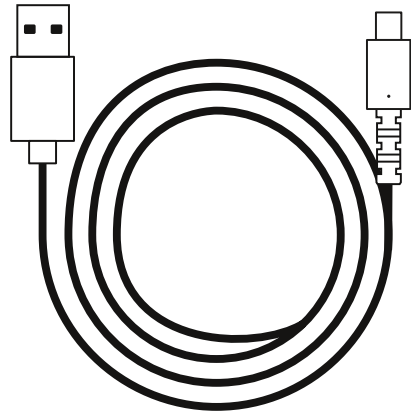
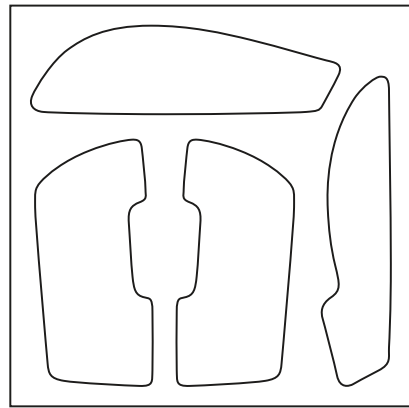
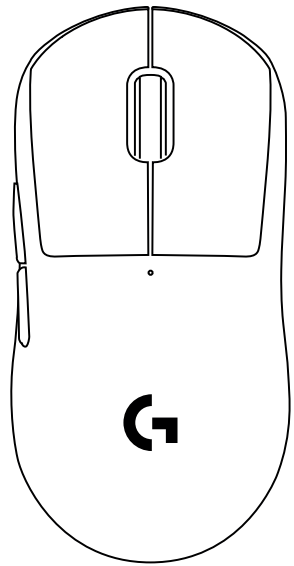

ENGLISH . . . . .	3
FRANÇAIS. . . . .	10
ESPAÑOL . . . . .	17
PORTUGUÊS . . . . .	24

# PACKAGE CONTENTS

- 1 Mouse
- 2 Optional grip tape
- 3 Receiver (installed in extension adapter)
- 4 USB charging and data cable
- 5 Surface preparation cloth
- 6 Optional POWERPLAY aperture door with PTFE foot

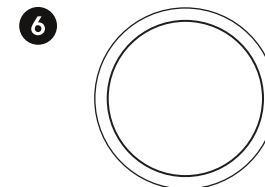
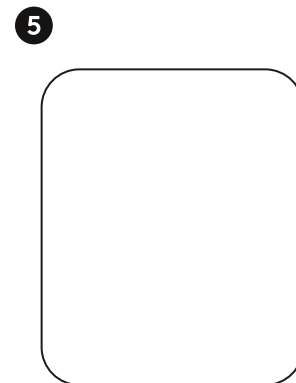
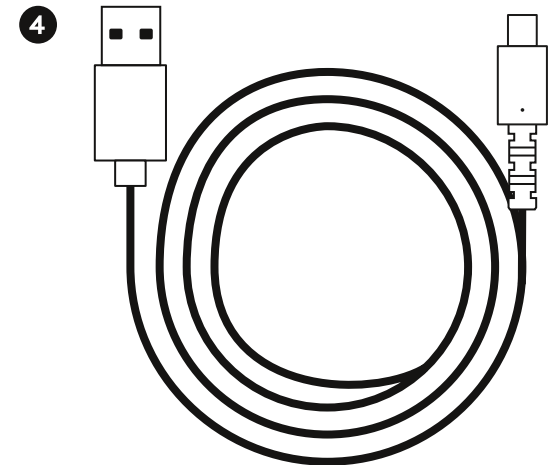
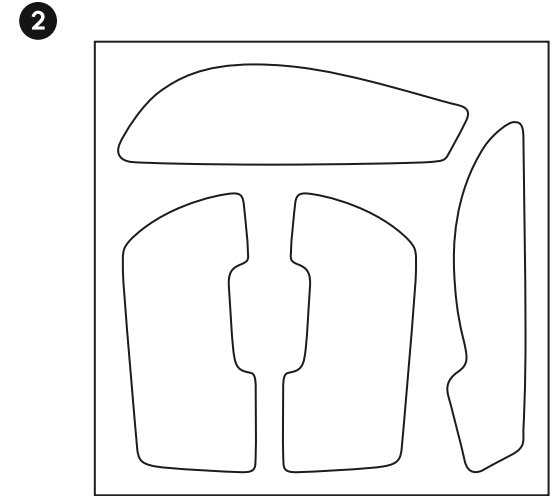
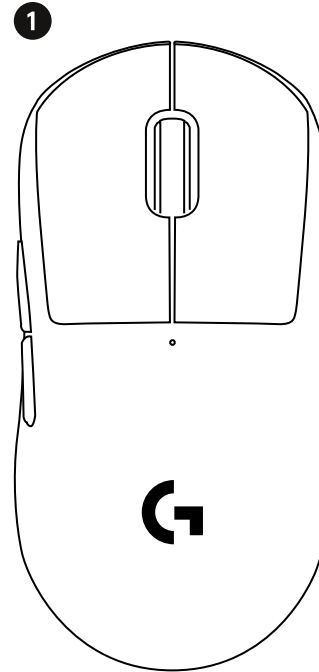

# MOUSE FEATURES

- 1 Left Click
- 2 Right Click
- 3 Middle Click/Scroll
- 4 Browser Forward
- 5 Browser Back
- 6 Power LED
- 7 USB charging/data port
- 8 Power on/off
- 9 POWERPLAY Aperture door

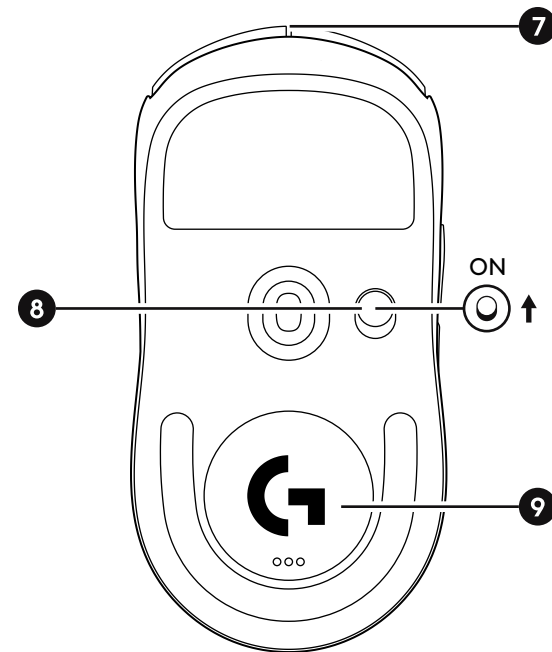
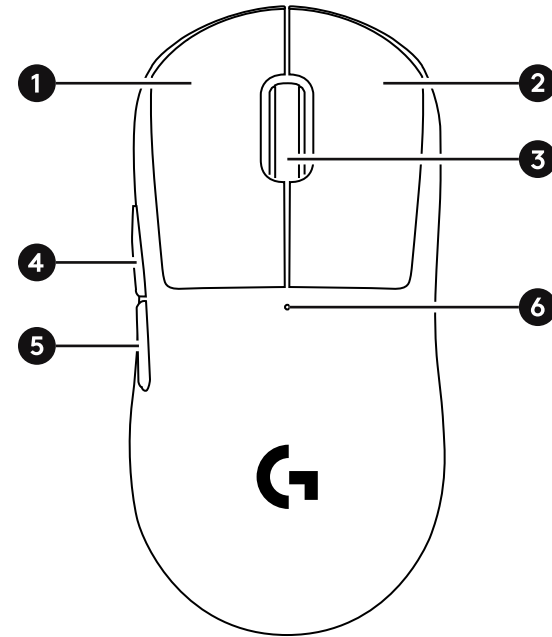

# SETUP

- 1 Plug charging/data cable into PC, then plug extension adapter and receiver into charging/data cable.

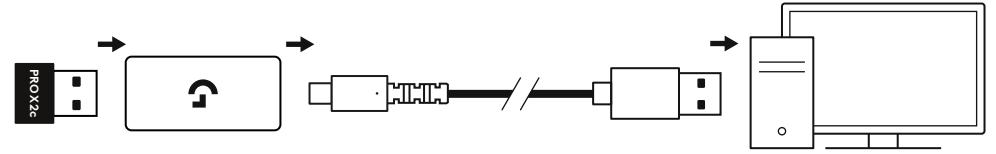

- 2 Turn on mouse.

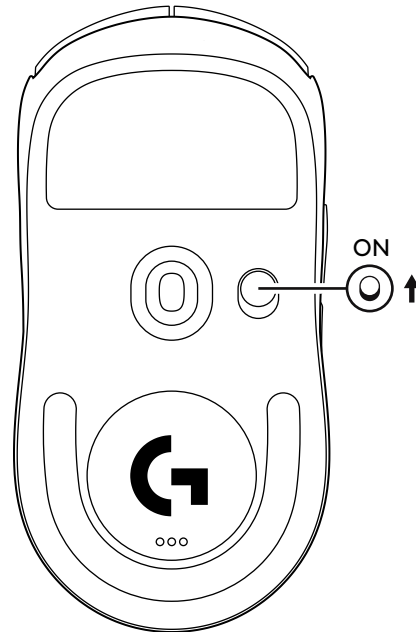

- 3 To configure mouse settings like DPI or report rate, download G HUB software from [logitechG.com/GHUB](https://logitechG.com/GHUB)

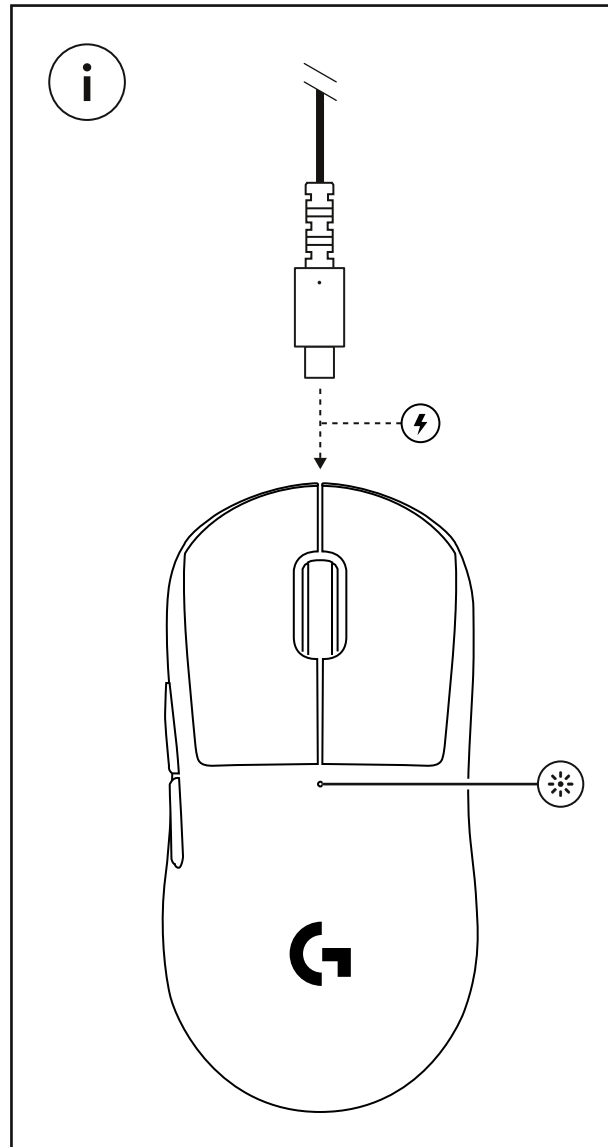
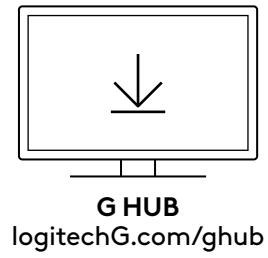

For optimal wireless performance, use mouse within 20 cm of receiver and greater than 2 m from sources of 2.4GHz interference (such as wifi routers).

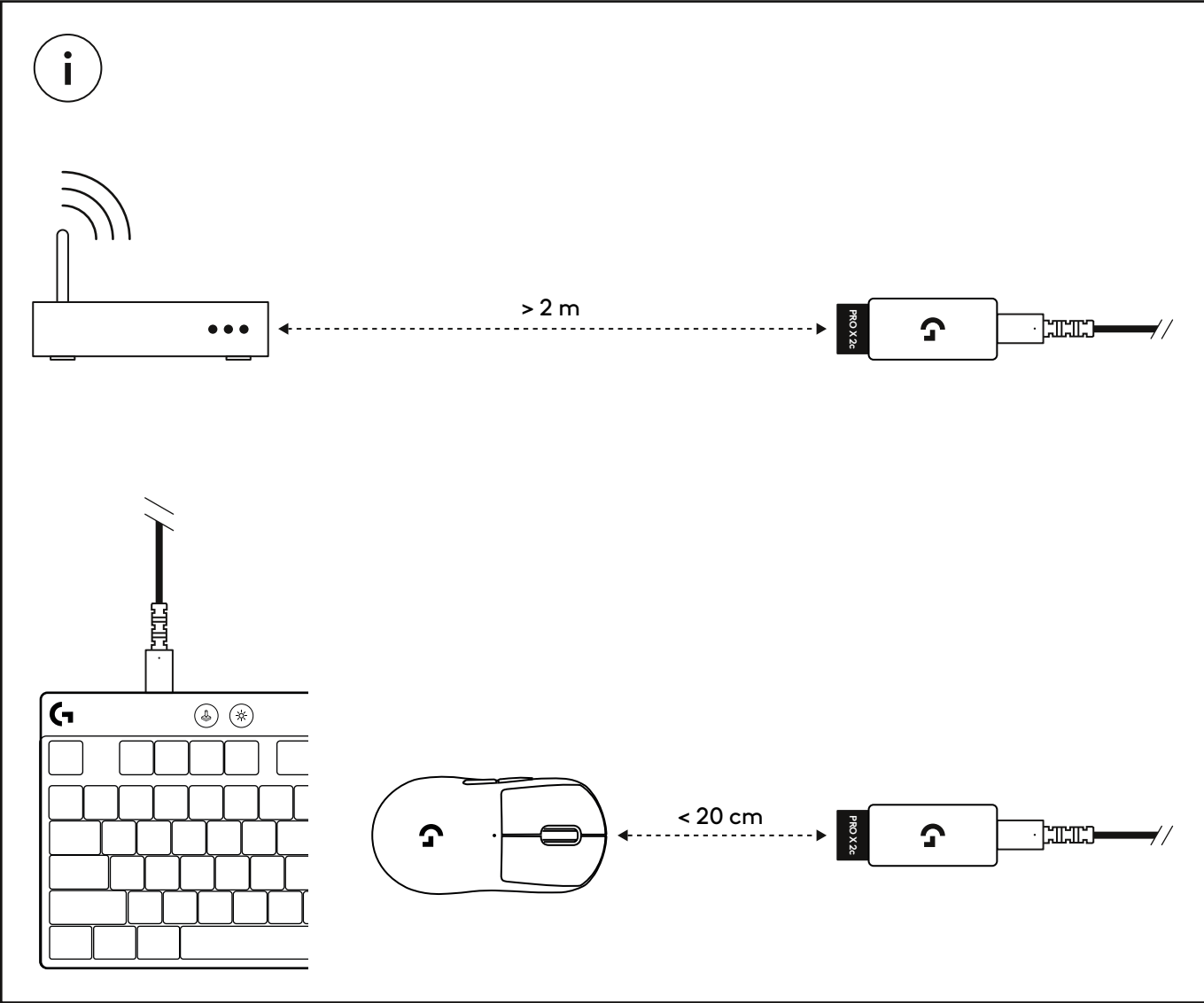

To install optional grip tape, first clean surface of mouse with provided surface preparation cloth to remove any oil or dust. Then, carefully align grip tape to mouse surfaces.

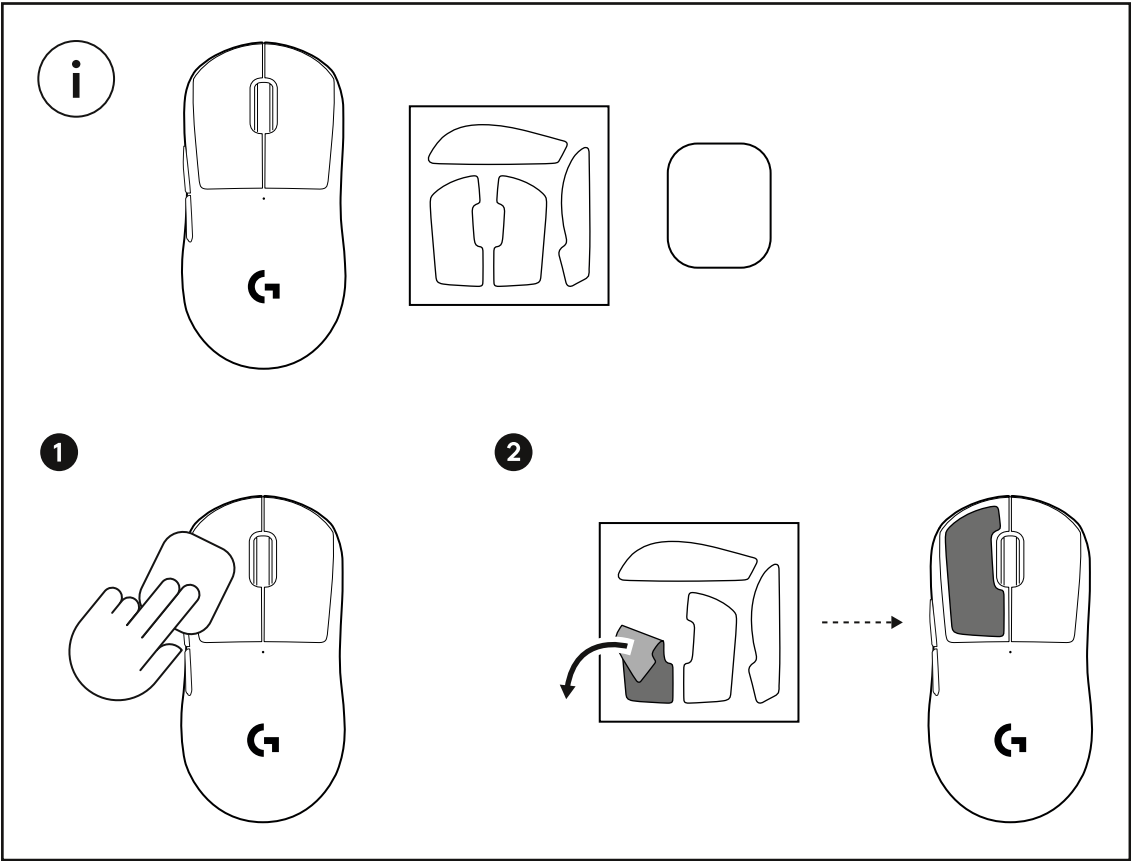

The USB receiver can be stored inside the mouse by removing the POWERPLAY aperture door. This can prevent the receiver from being lost when using the mouse with the Logitech G POWERPLAY wireless charging system.

Removing this door also allows the included, optional aperture door with PTFE foot to be installed instead of the default aperture door.

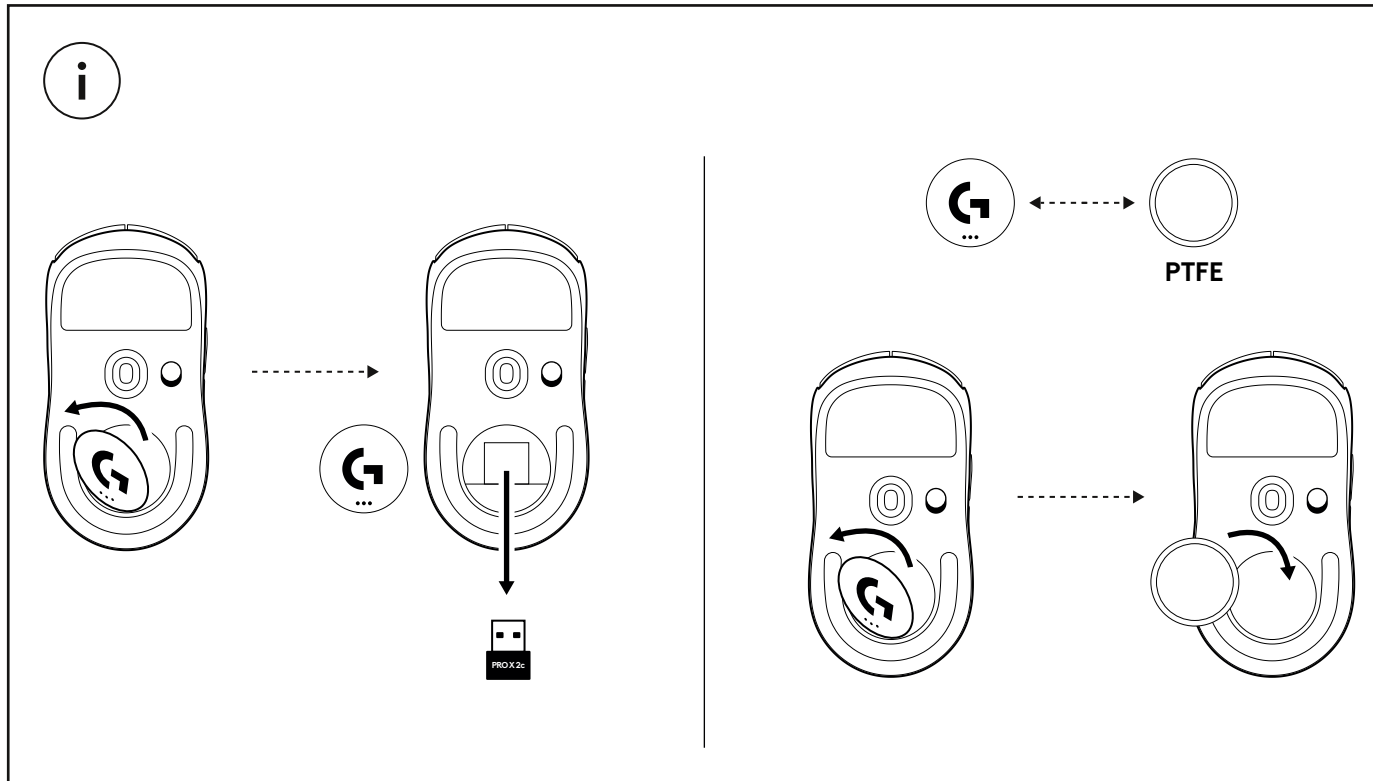

# CONTENU DU COFFRET

- 1 Souris
- 2 Bande antidérapante optionnelle
- 3 Récepteur (installé dans l'adaptateur d'extension)
- 4 Câble de charge USB et câble de données
- 5 Tissu de préparation de la surface
- 6 Compartiment à ouverture optionnelle POWERPLAY avec patin PTFE

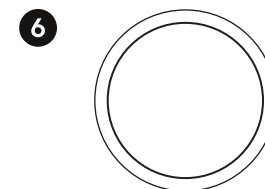
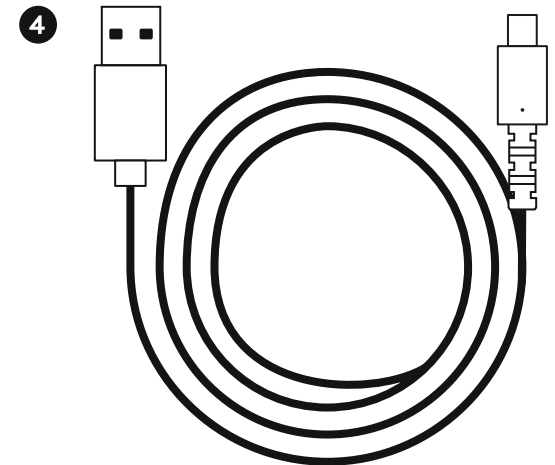
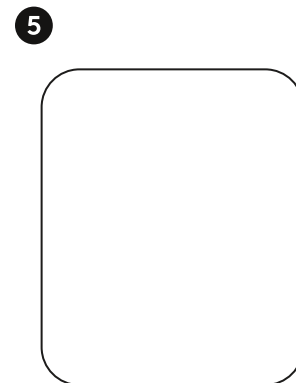
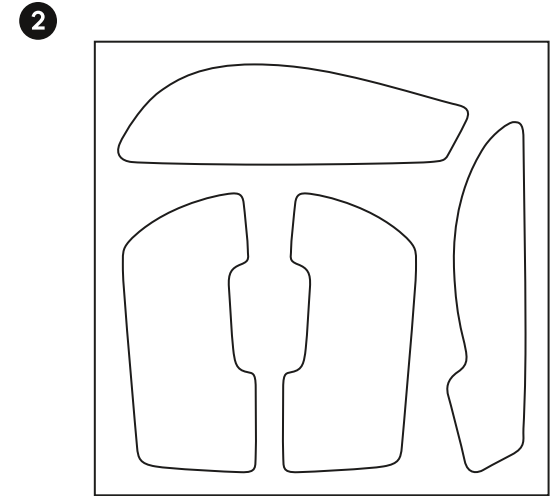
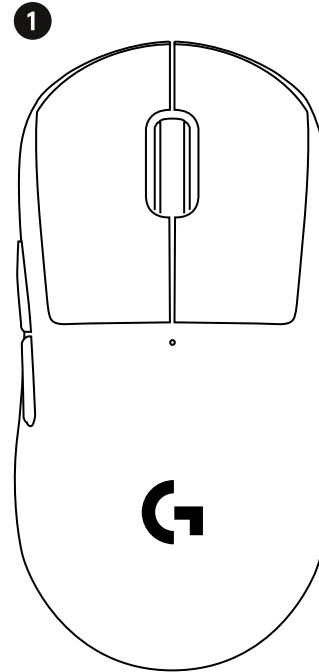

# CARACTÉRISTIQUES DE LA SOURIS

- 1 Clic gauche
- 2 Clic droit
- 3 Clic central/roulette de défilement
- 4 Avancer d'une page dans le navigateur
- 5 Reculer d'une page dans le navigateur
- 6 Témoin d'alimentation
- 7 Port USB de charge/données
- 8 Marche/Arrêt
- 9 Compartiment d'ouverture POWERPLAY

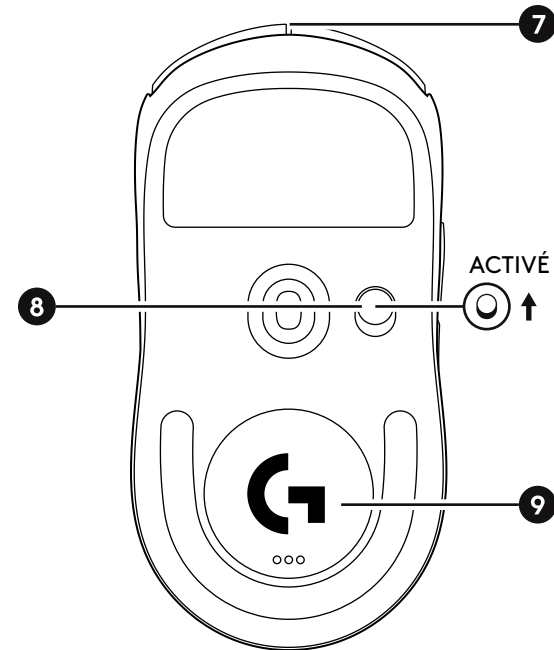
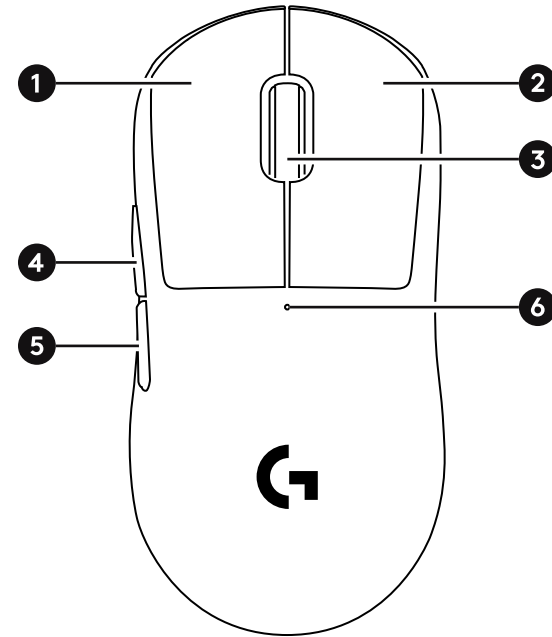

# INSTALLATION

- 1 Connectez le câble de charge/données sur le PC, puis l'adaptateur d'extension et le récepteur au câble de charge/données.

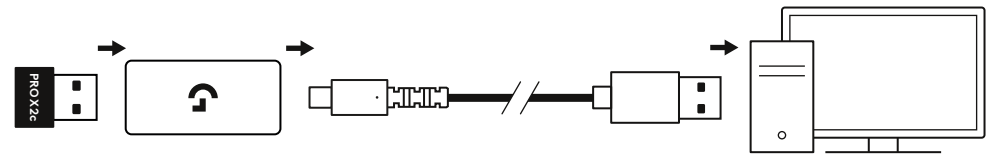

- 2 Allumez la souris.

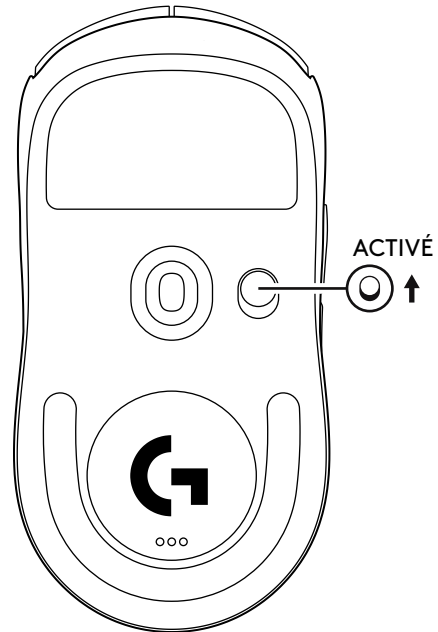

- 3 Pour configurer les paramètres de la souris, comme sa résolution ou son taux de rapport, téléchargez le logiciel G HUB à l'adresse [logitechG.com/GHUB](https://logitechG.com/GHUB)

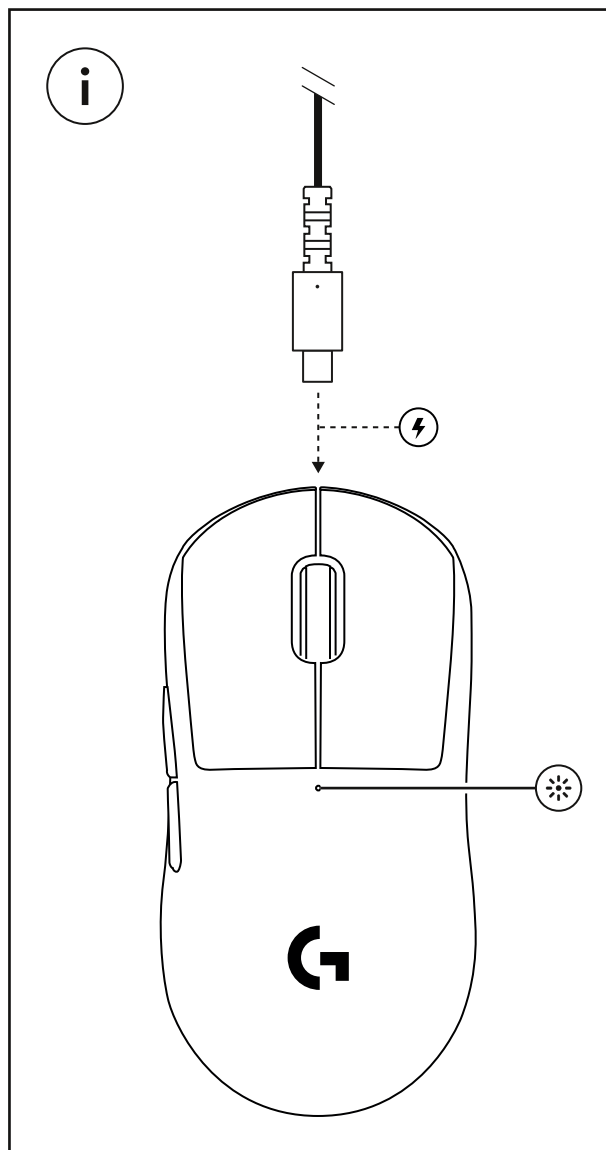
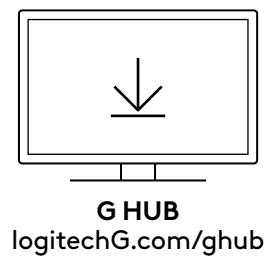

Pour bénéficier de performances optimales en mode sans fil, utilisez la souris dans un rayon de 20 cm autour du récepteur et à plus de 2 m des sources d'interférence à 2,4 GHz (notamment les routeurs Wi-Fi).

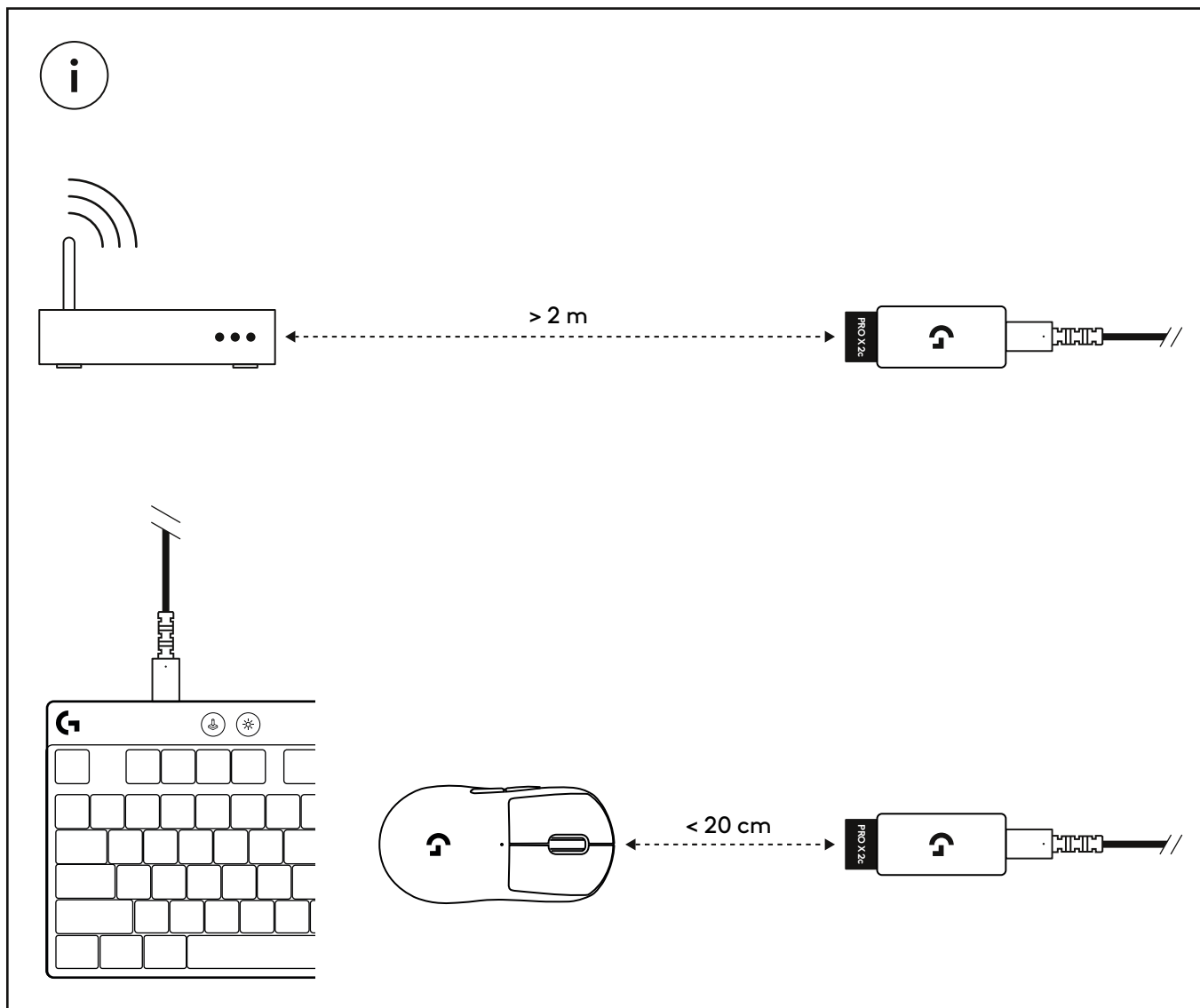

Pour installer la bande antidérapante optionnelle, commencez par nettoyer la surface de la souris avec le tissu de préparation de surface pour retirer tout résidu de graisse ou de poussière. Positionnez ensuite soigneusement la bande antidérapante sur les surfaces de la souris.

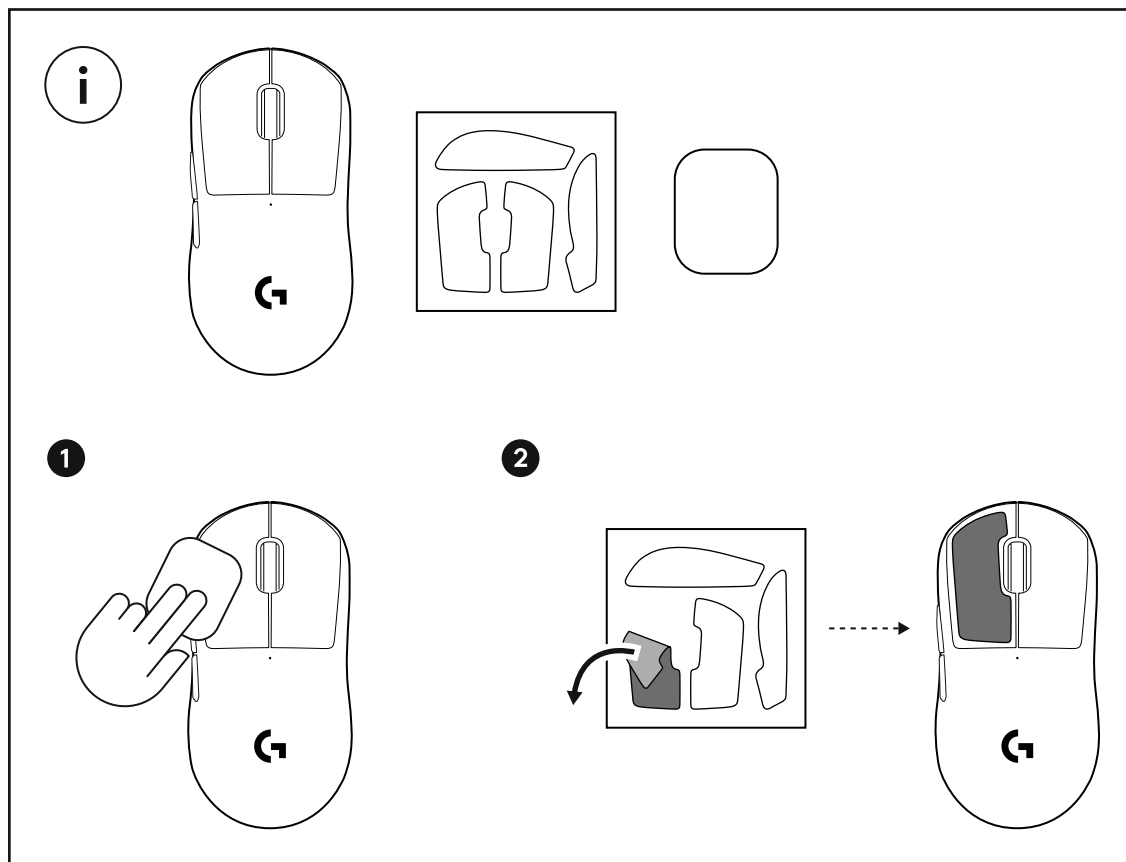

Le récepteur USB peut être stocké à l'intérieur de la souris en retirant le compartiment d'ouverture POWERPLAY. Cela permet d'éviter de perdre le récepteur lorsque la souris est utilisée avec le système de charge sans fil Logitech G POWERPLAY.

Retirer ce compartiment permet d'installer le compartiment à ouverture optionnelle avec patin PTFE au lieu du compartiment d'ouverture par défaut.

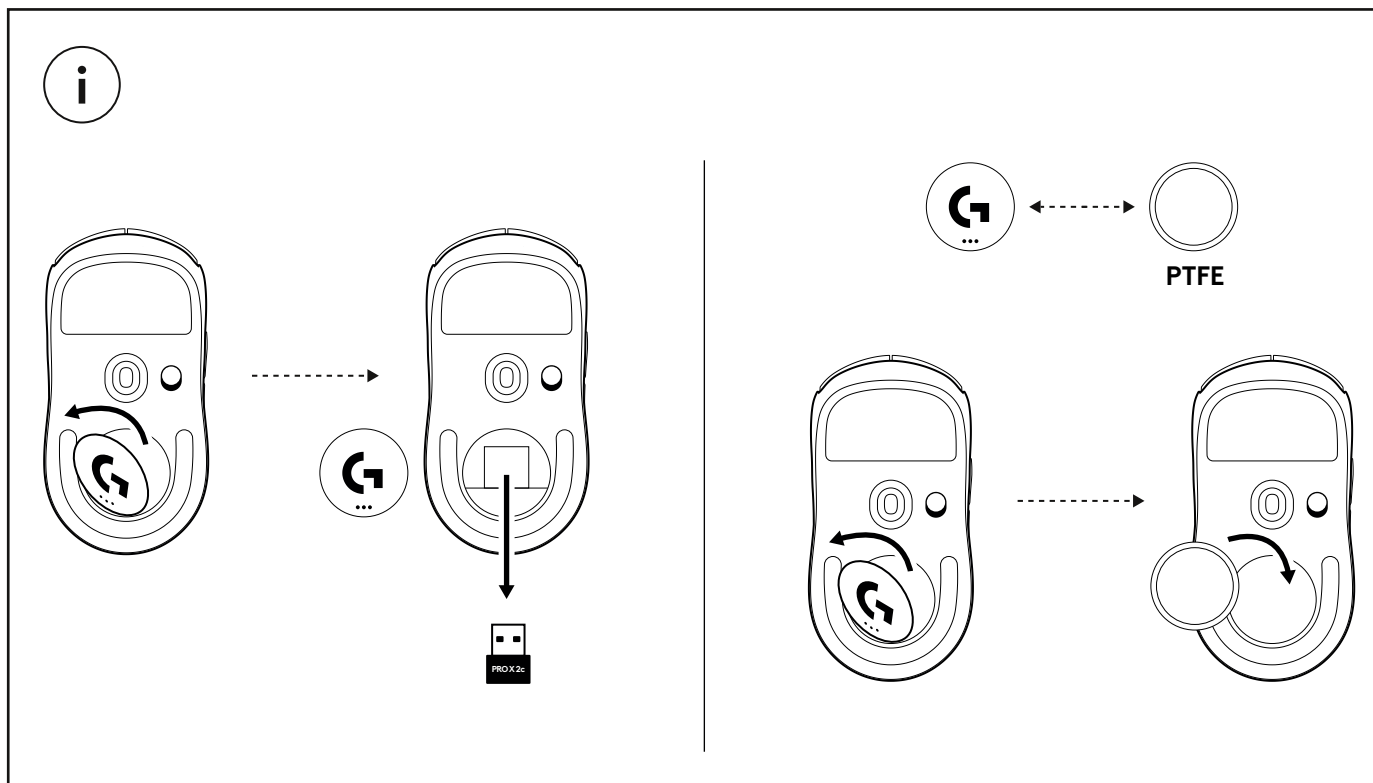

# CONTENIDO DE LA CAJA

- 1 Ratón
- 2 Cinta de agarre opcional
- 3 Receptor (instalado en adaptador de extensión)
- 4 Cable de carga y datos USB
- 5 Paño de preparación de superficie
- 6 Puerta de apertura opcional POWERPLAY con pie de PTFE

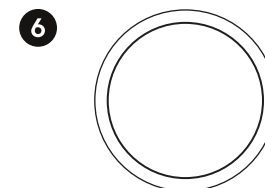
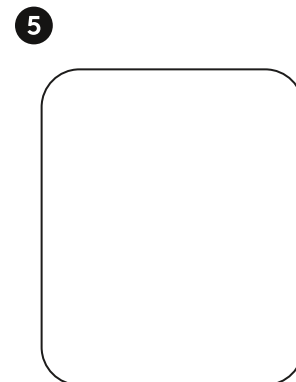
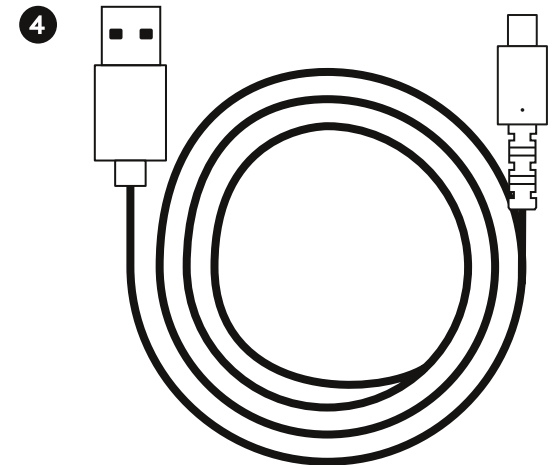
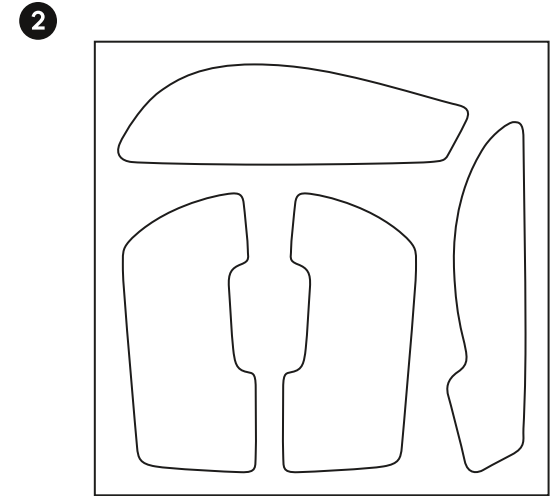
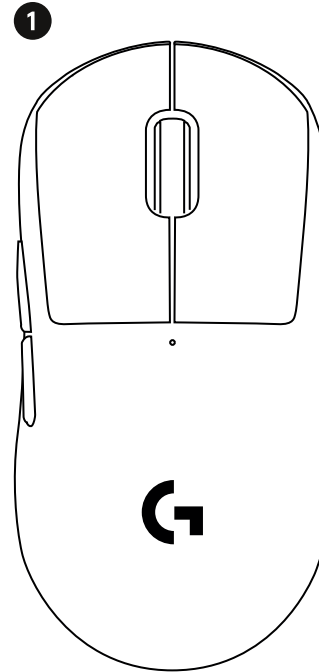

# CARACTERÍSTICAS DEL RATÓN

- 1 Clic de botón izquierdo
- 2 Clic de botón derecho
- 3 Clic de botón central/Desplazamiento
- 4 Avance en navegador
- 5 Retroceso en navegador
- 6 LED de encendido
- 7 Puerto de carga/datos USB
- 8 Encendido/apagado
- 9 Puerta de apertura POWERPLAY

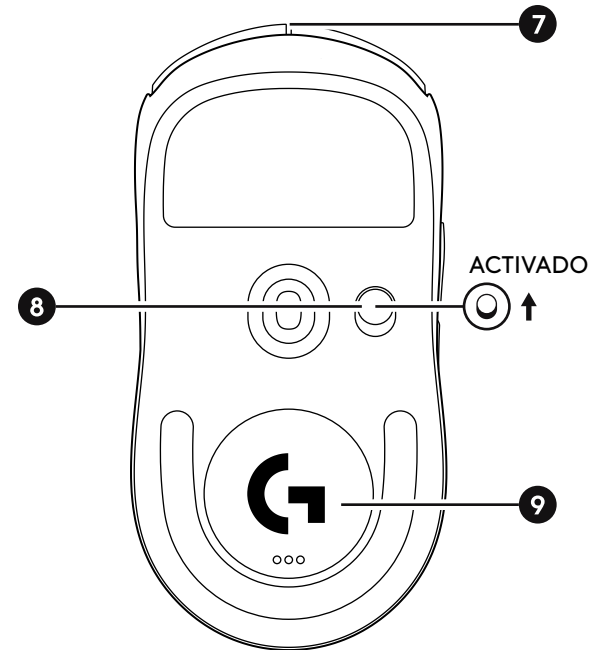
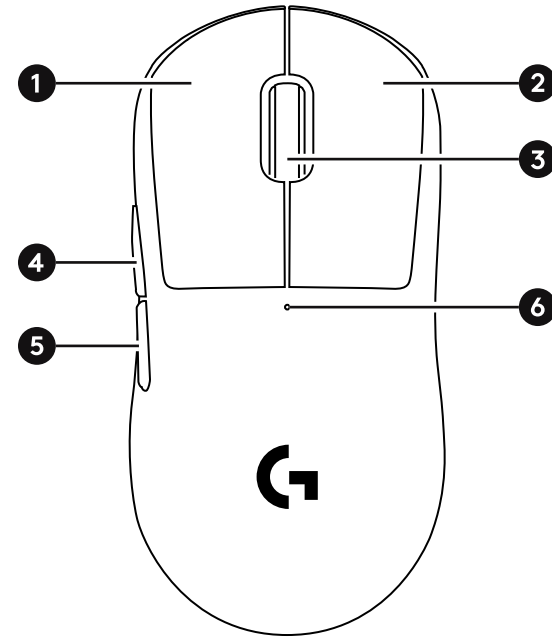

# PROCEDIMIENTO

- 1 Conecta el cable de carga/datos al PC y luego conecta el adaptador de extensión y el receptor al cable de carga/datos.

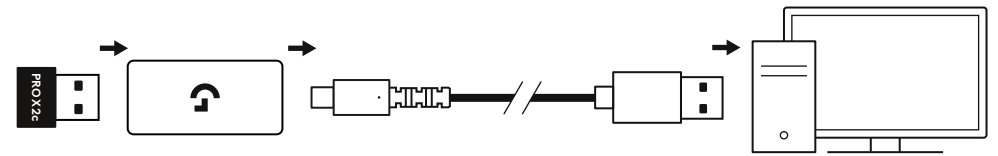

- 2 Enciende el ratón.

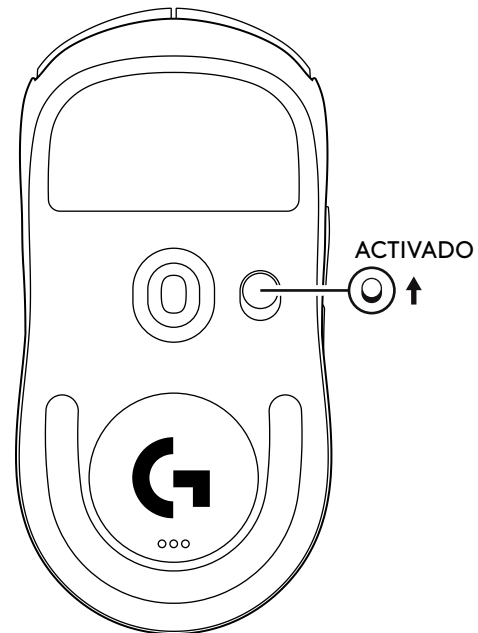

- 3 Para configurar opciones del ratón como el valor de DPI o la velocidad de respuesta, descarga el software G HUB desde [logitechG.com/GHUB](https://logitechG.com/GHUB)

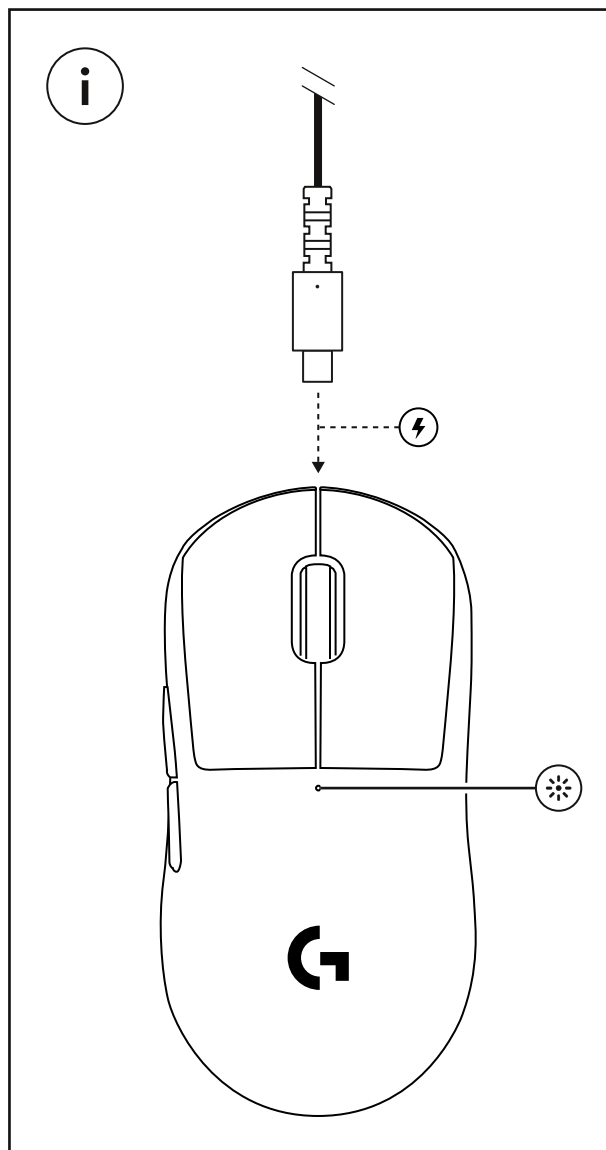
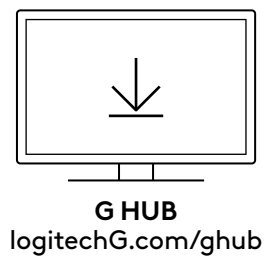

Para un óptimo rendimiento inalámbrico, usa el ratón a menos de 20 cm del receptor y a más de 2 metros de fuentes de interferencias de 2,4 GHz (como enrutadores wifi).

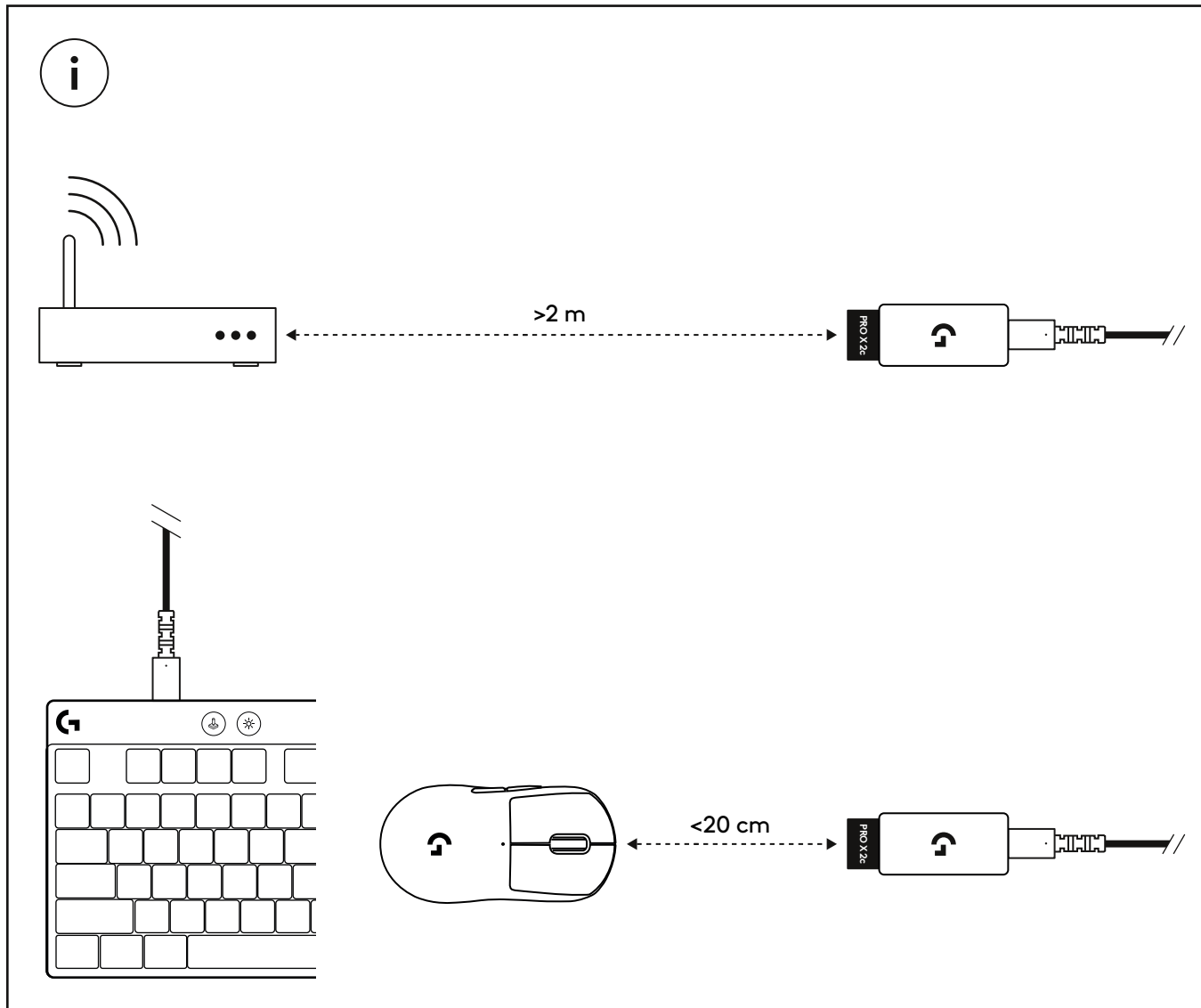

Para instalar la cinta de agarre opcional, limpia primero la superficie del ratón con el paño de preparación de superficie suministrado para eliminar posibles residuos de grasa o polvo. Luego, alinea con cuidado la cinta de agarre con las superficies del ratón.

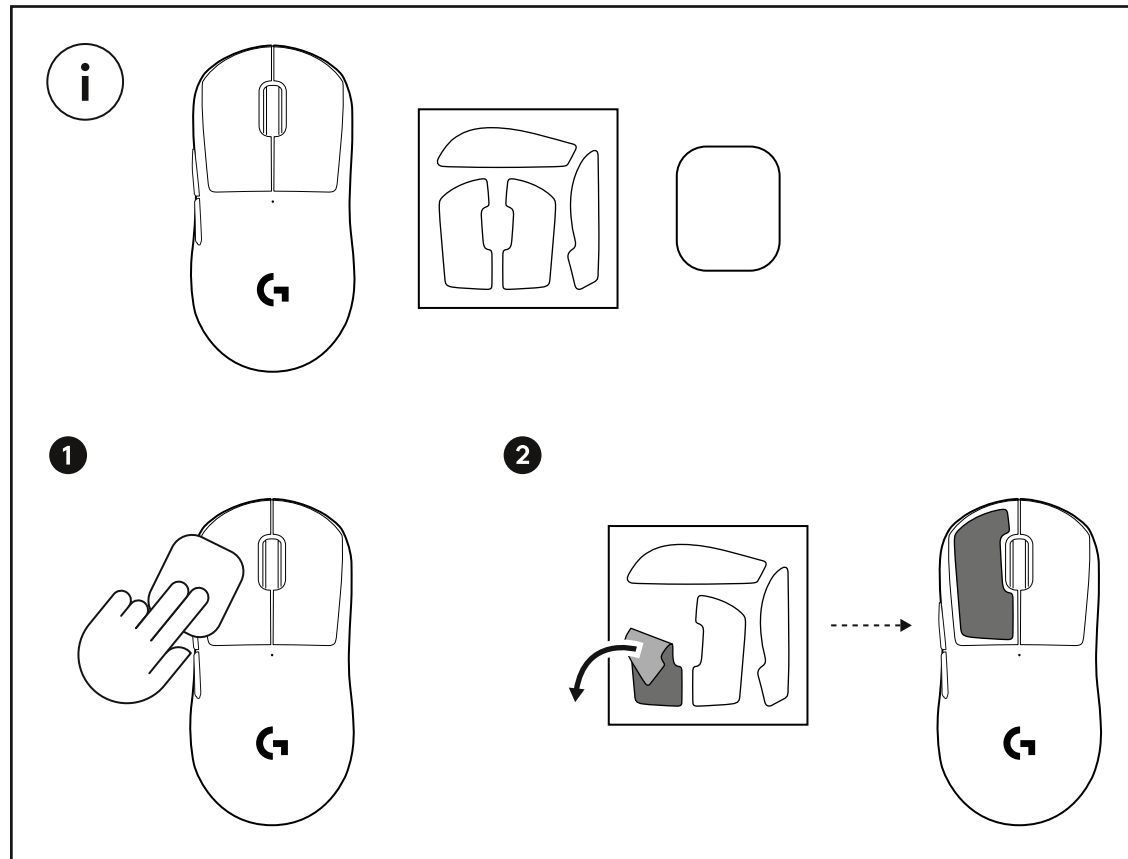

El receptor USB se puede guardar en el interior del ratón si retiras la puerta de apertura POWERPLAY.  
Esto puede impedir la pérdida del receptor cuando se usa el ratón con el sistema inalámbrico de carga  
Logitech G POWERPLAY.

Retirar esta puerta también permite instalar la puerta de apertura opcional con pie de PTFE, incluida, en lugar  
de la puerta de apertura predeterminada.

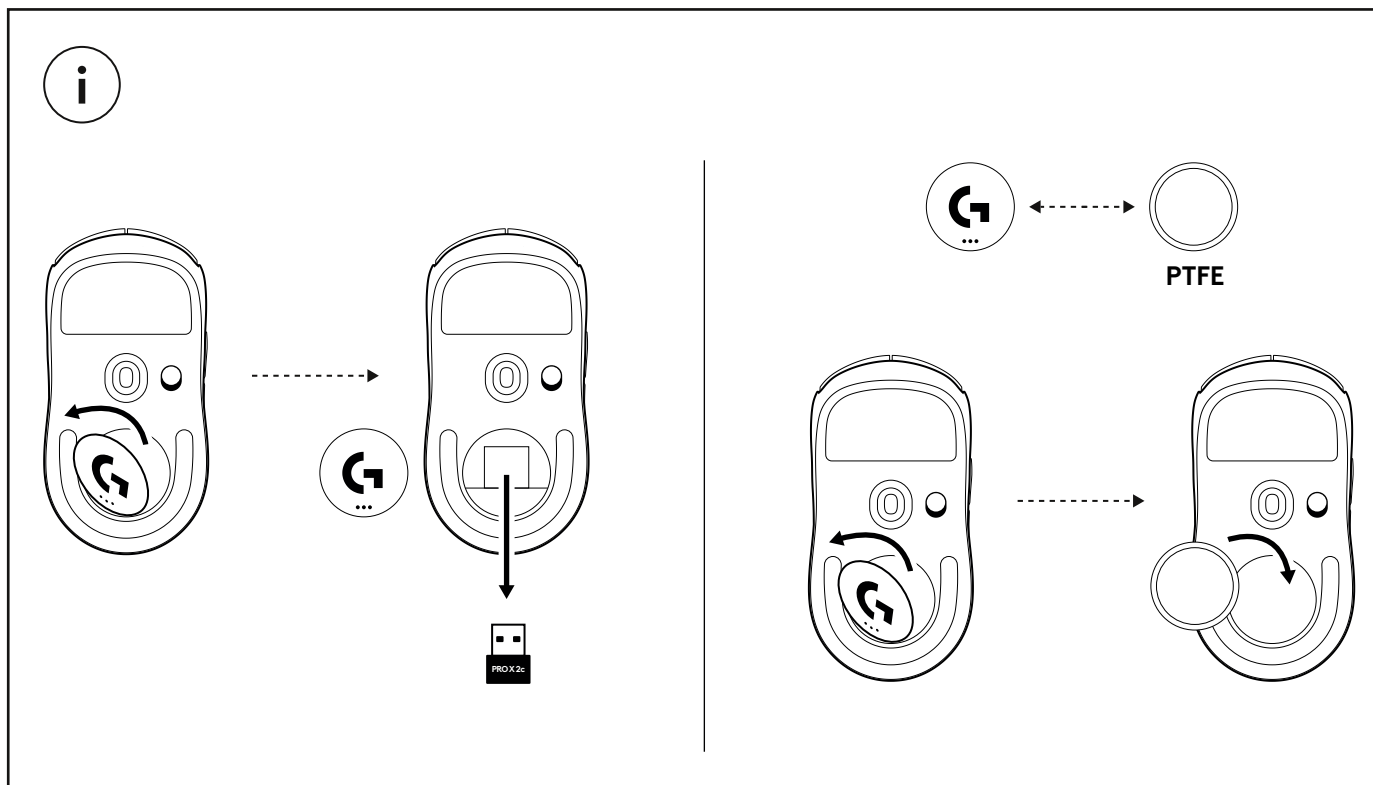

# CONTEÚDO DA EMBALAGEM

- 1 Rato
- 2 Fita de aderência opcional
- 3 Recetor (instalado no adaptador de extensão)
- 4 Cabo USB de carregamento e dados
- 5 Pano de limpeza da superfície
- 6 Porta de abertura POWERPLAY opcional com suportes de PTFE

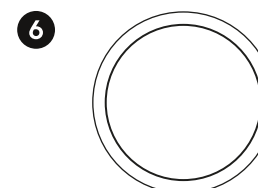
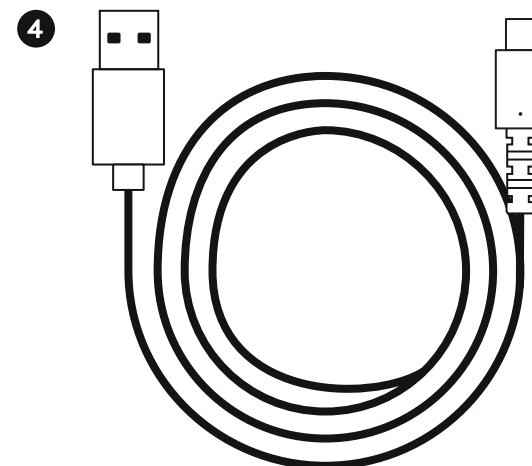
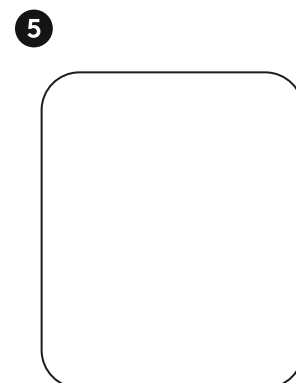
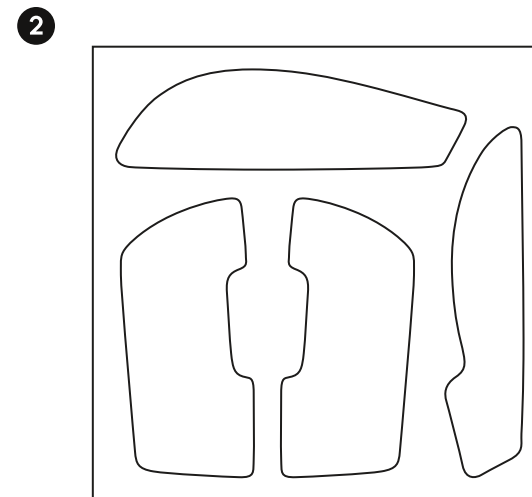
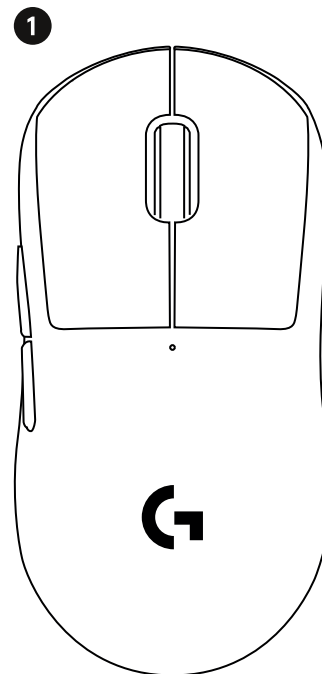

# FUNCIONALIDADES DO RATO

- 1 Clique esquerdo
- 2 Clique direito
- 3 Clique do botão intermédio/Deslocamento
- 4 Avançar no browser
- 5 Retroceder no browser
- 6 LED Ligar/Desligar
- 7 Carregamento USB/porta de dados
- 8 Ligar/Desligar
- 9 Porta de abertura POWERPLAY

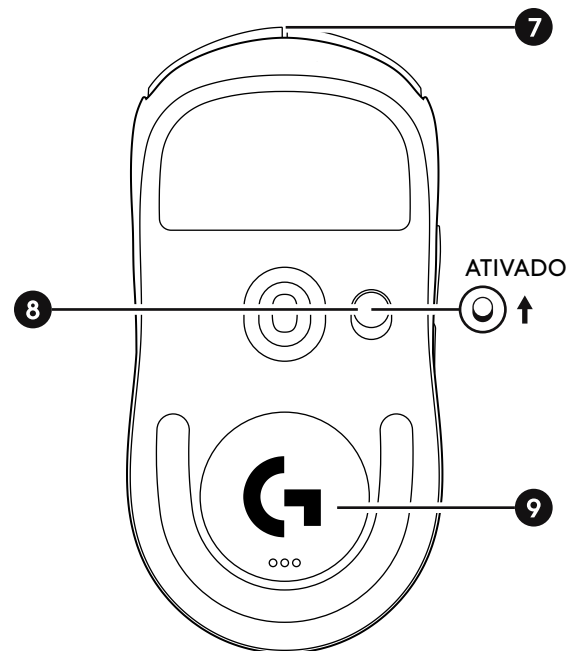
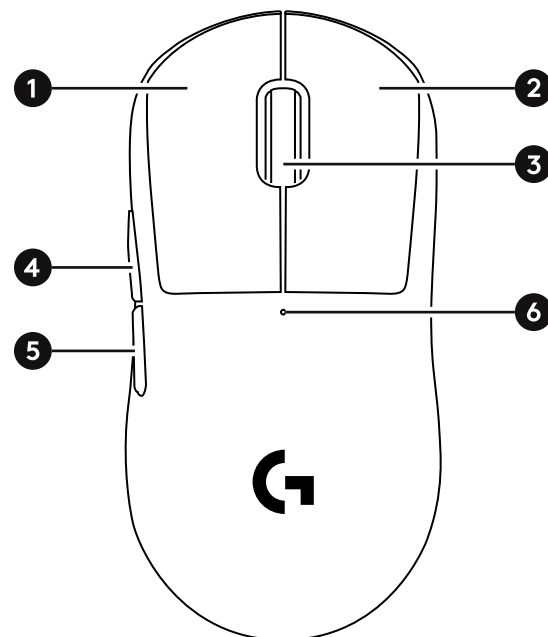

# INSTALAÇÃO

- 1 Ligue o cabo de carregamento/dados ao PC e, em seguida, ligue o adaptador de extensão e o recetor ao cabo de carregamento/dados.

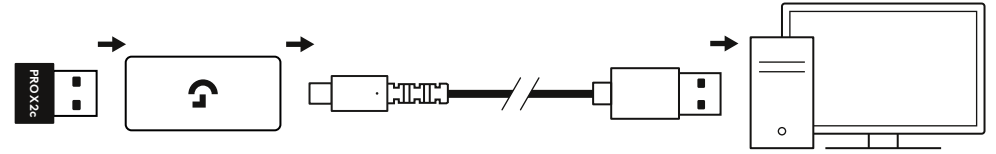

- 2 Ligue o rato.

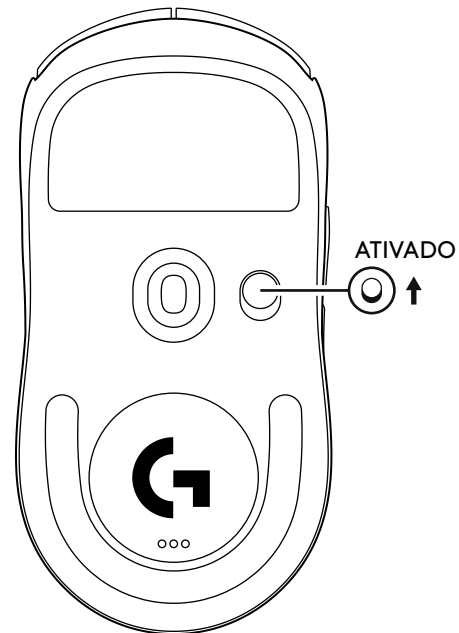

- 3 Para configurar as definições do rato, como PPP ou a taxa de relatório transfira o software G HUB em [logitechG.com/GHUB](https://logitechG.com/GHUB)

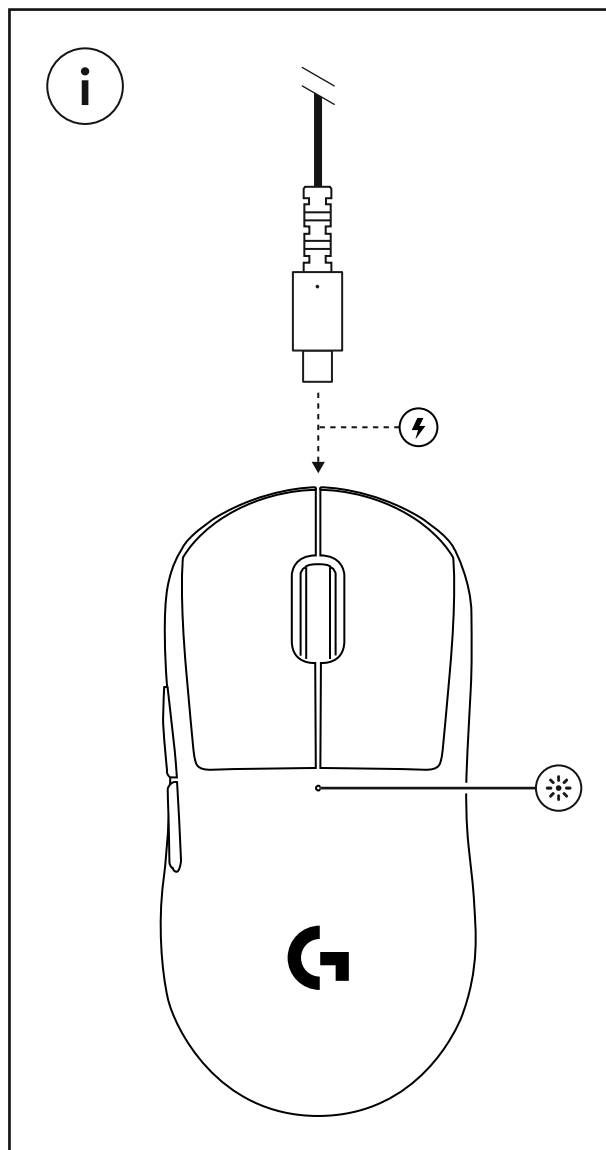
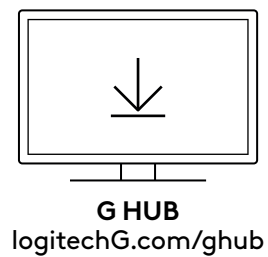

Para obter o melhor desempenho, utilize o rato a uma distância máxima de 20 cm do recetor e a mais de 2 m de fontes de interferência de 2,4 GHz (por exemplo, routers Wi-Fi).

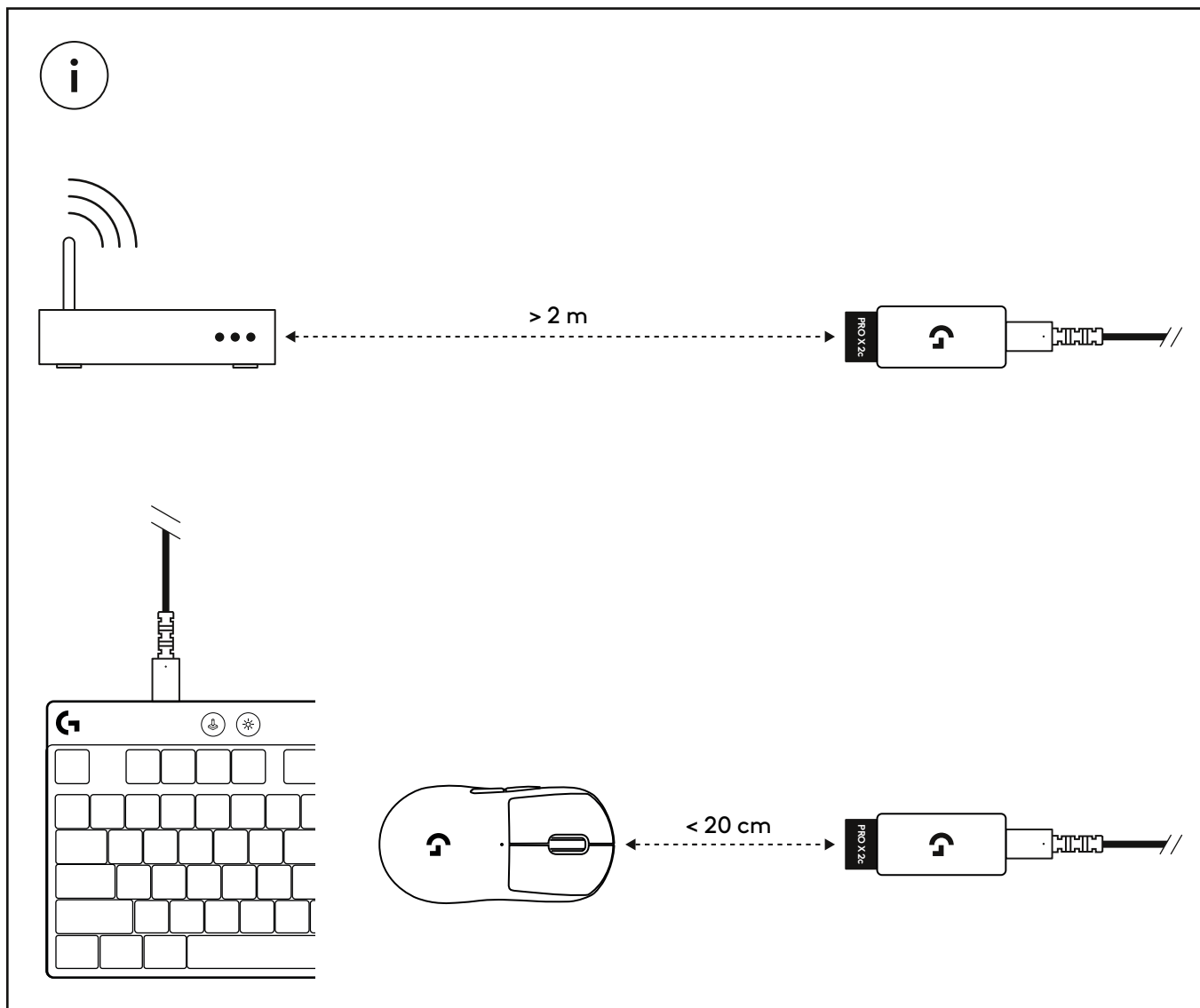

Para instalar a fita de aderência, limpe primeiro a superfície do rato com o pano de limpeza fornecido para remover o pó ou óleo. Em seguida, alinhe cuidadosamente a fita de aderência nas superfícies do rato.

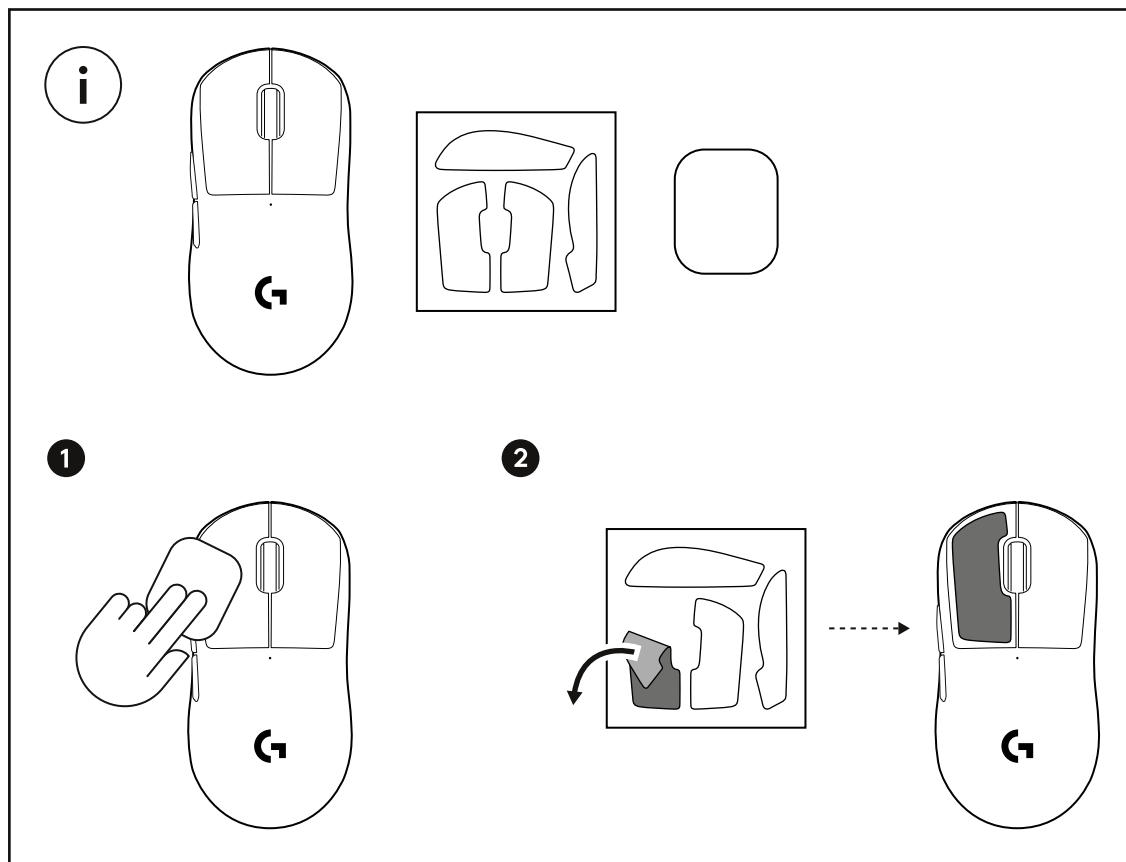

Pode guardar o recetor USB no interior do rato removendo a porta de abertura POWERPLAY. Assim, pode evitar perder o recetor quando utiliza o rato com o sistema de carregamento sem fios Logitech G POWERPLAY.

Se remover esta porta, também permite instalar a porta de abertura opcional com suportes de PTFE em vez da porta de abertura pré-instalada.

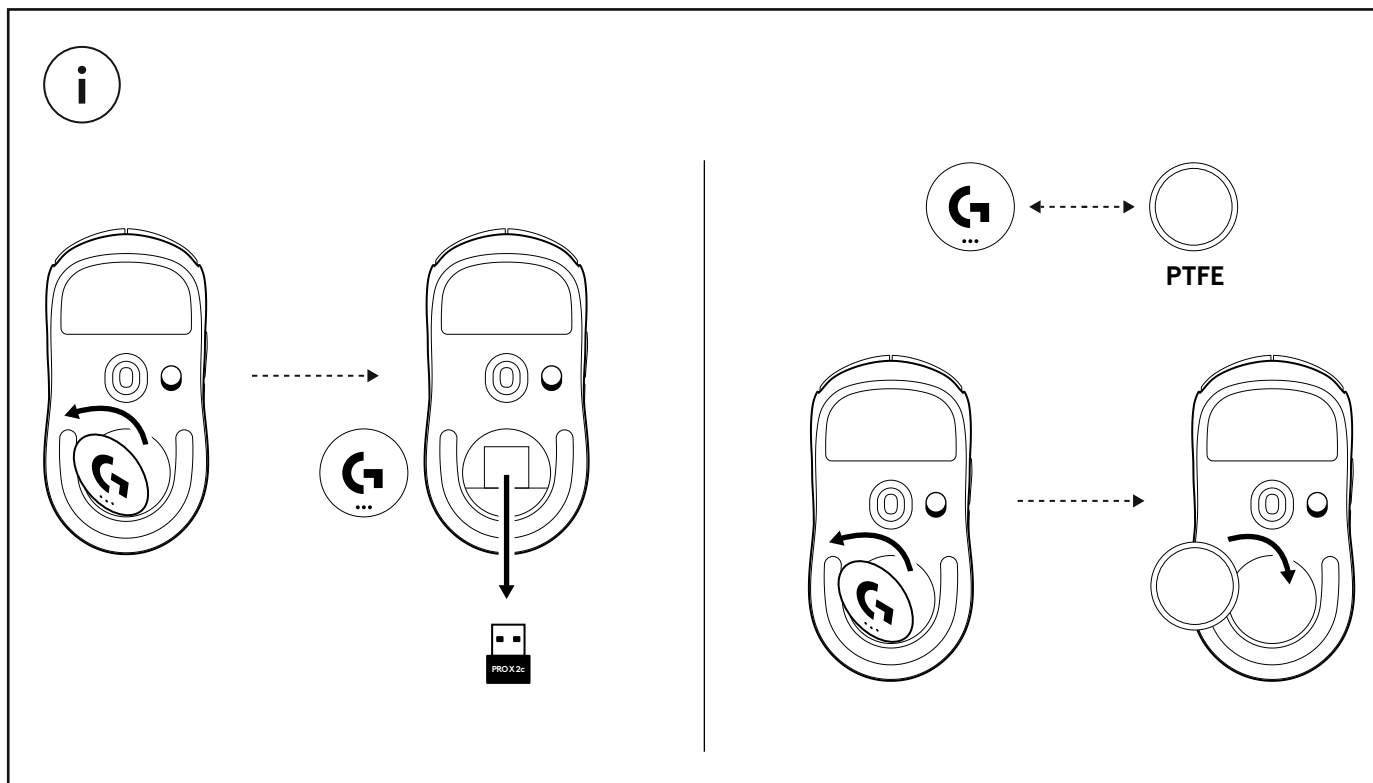



©2025 Logitech. Logitech, Logitech G, LIGHTFORCE, LIGHTSPEED, and POWERPLAY and their respective logos are trademarks or registered trademarks of Logitech Europe S.A. and/or its affiliates in the U.S. and other countries. Windows is a trademark of the Microsoft Corporation. USB-C is a trademark of USB Implementers Forum. All other third party trademarks are the property of their respective owners.

©2025 Logitech. Logitech, Logitech G, LIGHTFORCE, LIGHTSPEED, POWERPLAY et leurs logos sont des marques commerciales ou déposées de Logitech Europe S.A. et/ou de ses sociétés affiliées aux États-Unis et dans d'autres pays. Windows est une marque déposée de Microsoft Corporation. USB-C est une marque commerciale d'USB Implementers Forum. Toutes les autres marques déposées tierces sont la propriété de leurs détenteurs respectifs.

WEB-621-002659 002